

sc1000 Panel Mount Bracket

Safety information

Please read this entire document before unpacking, setting up, or operating this equipment. Pay attention to all danger and caution statements. Failure to do so could result in serious injury to the operator or damage to the equipment.

To ensure that the protection provided by this equipment is not impaired, do not use or install this equipment in any manner other than that specified in this document.



Electrical equipment marked with this symbol may not be disposed of in European public disposal systems after 12 August of 2005. In conformity with European local and national regulations (EU Directive 2002/96/EC), European electrical equipment users must now return old or end-of life equipment to the Producer for disposal at no charge to the user.

Note: For return for recycling, please contact the equipment producer or supplier for instructions on how to return end-of-life equipment, producer-supplied electrical accessories, and all auxiliary items for proper disposal.

Introduction

The panel mount bracket is used to mount the sc1000 display module in locations where the display module and probe module must be mounted on opposite sides of a control panel. The display module is connected by an extension cable (15 m maximum).

Note: Refer to the sc1000 User Manual (Cat. No. DOC023.54.03260) for probe module mounting instructions.

Packing list

The sc1000 panel mount installation kit includes the following components, shown in [Figure 2 on page 3](#):

- Probe extension cable, 7.7 m (item [2](#))
- Panel mount bracket (item [8](#))
- Modified strain relief (items [3–7](#))
- Installation instructions

Customer-supplied hardware

- Screws, pan head, # 10, or equivalent low profile head screws (x3)

Panel mount bracket installation

- 1. Determine the location of the bracket on the panel. Allow enough room for the strain relief pass-through or optional bulkhead connector pass-through to be located within a 228.6 mm (9 in.) radius of the bottom mounting screw (Figure 1).
- 2. Install three customer-supplied # 10 pan head or equivalent low profile head screws into the panel (Figure 1, item 1).
- 3. Hang the sc1000 panel mount bracket over the screws.
- 4. Hang the sc1000 display module on the panel mount bracket (Figure 2, item 8).
- 5. Drill the pass-through hole for the strain relief fitting or the optional bulkhead connector within a 9-inch radius from the bottom mounting screw location (Figure 1).

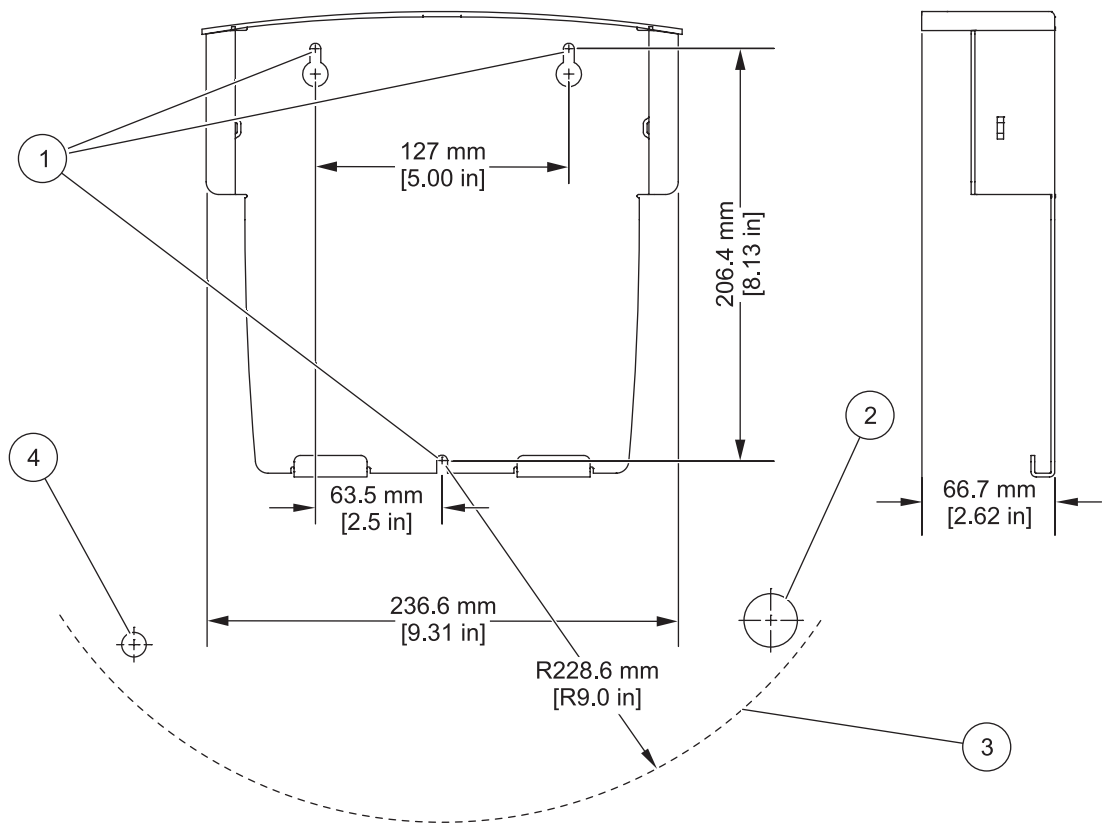

Figure 1 Panel mount dimensions

1	Bracket mounting holes (3x)	3	Maximum 9-inch radius for pass-through holes
2	Pass-through hole, 26.746 mm (1.053 in.), for strain relief (supplied)	4	Pass-through hole, 12.319 ± 0.381 mm (0.485 ± 0.015 in.) for optional bulkhead connector (Cat. No. 71211-00, not supplied)

Modified strain relief installation

1. Thread the O-ring (Figure 2, item 4) onto the strain relief body.
2. Install the strain relief fitting into the panel pass-through hole. On the probe module side of the panel, thread the lock nut (Figure 2, item 3) onto the strain relief and hand-tighten.
3. Thread the extension cable through the strain relief (Figure 2, item 2).
4. Install the bushing (Figure 2, item 6) onto the extension cable. Note the orientation in Figure 2.
5. At the clamping fingers (Figure 2, item 5), rotate the bushing counter-clockwise and push the bushing into place in the strain relief.
6. Thread the nut (Figure 2, item 7) onto the extension cable and hand-tighten onto the strain relief.
7. Connect the extension cable to the display module cable and the probe module.

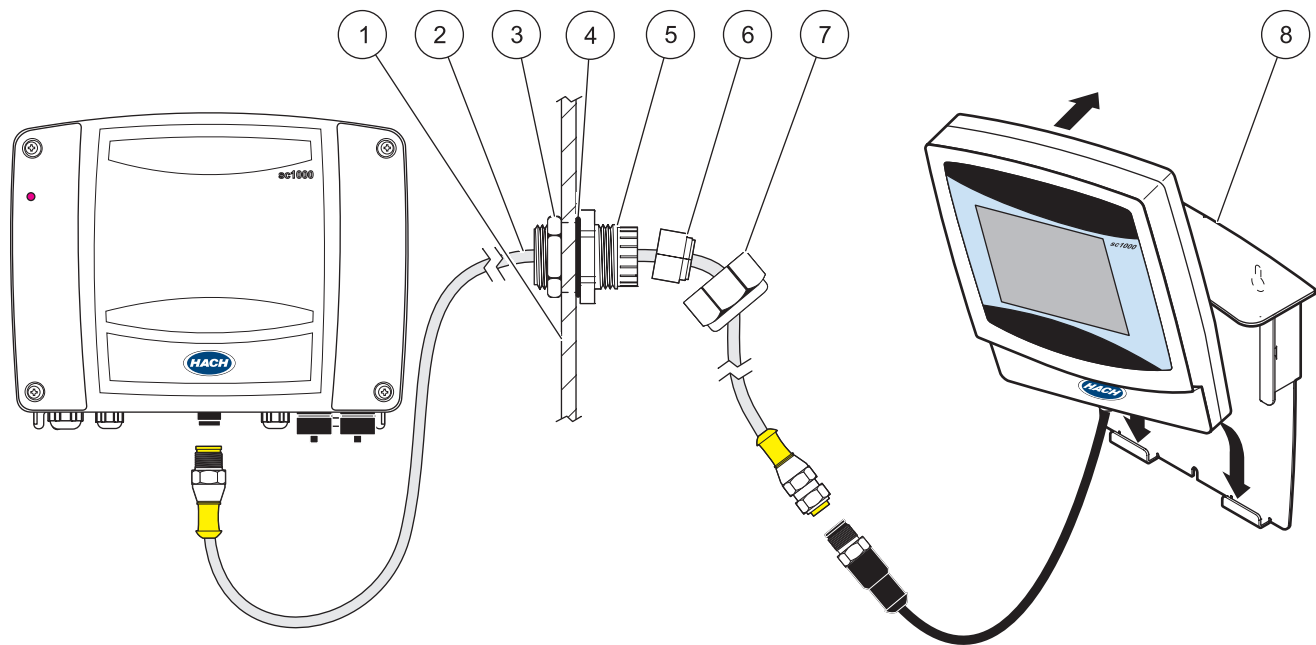

Figure 2 Instrument components

1 Mounting panel	5 Clamping fingers
2 Extension cable (maximum 15 feet)	6 Bushing (split)
3 Lock nut (probe module side)	7 Lock nut (display module side)
4 O-ring (Cat. No. 5H1017)	8 Panel mount bracket

Optional bulkhead connector installation

The optional bulkhead connector (Cat. No. 71211-00) is available for separate purchase for mounting on panels of ¼-inch or greater thickness.

- 1. Thread the isolator washer (Figure 3, item 4) onto the connector, noting the orientation.
- 2. From the display module side of the panel, thread the isolator washer (Figure 3, item 3), lock washer (Figure 3, item 2) and lock nut (Figure 3, item 1) onto the probe module side of the panel and hand-tighten.

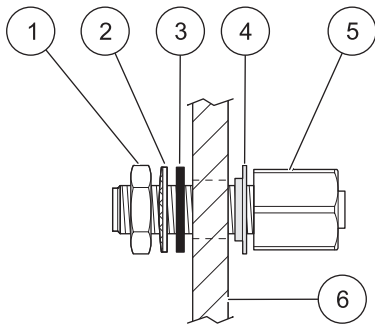

Figure 3 Optional bulkhead connector (Cat. No. 71211-00)

1	Lock nut (probe module side)	4	Isolator washer
2	Lock washer	5	Bulkhead connector housing
3	Isolator washer	6	Mounting panel

Replacement parts

Description	Quantity	Catalog Number
Strain Relief	1	6128701

Optional parts and accessories

Description	Quantity	Catalog Number
Connector, bulkhead	1	7121100
Extension Cable, 15 m	1	5796100



FOR TECHNICAL ASSISTANCE, PRICE INFORMATION AND ORDERING:
In the U.S.A. – Call toll-free 800-227-4224
Outside the U.S.A. – Contact the HACH office or distributor serving you.
On the Worldwide Web – www.hach.com; E-mail – techhelp@hach.com

HACH COMPANY
WORLD HEADQUARTERS
Telephone: (970) 669-3050
FAX: (970) 669-2932