

Mounting Hardware for Differential pH and ORP Sensors

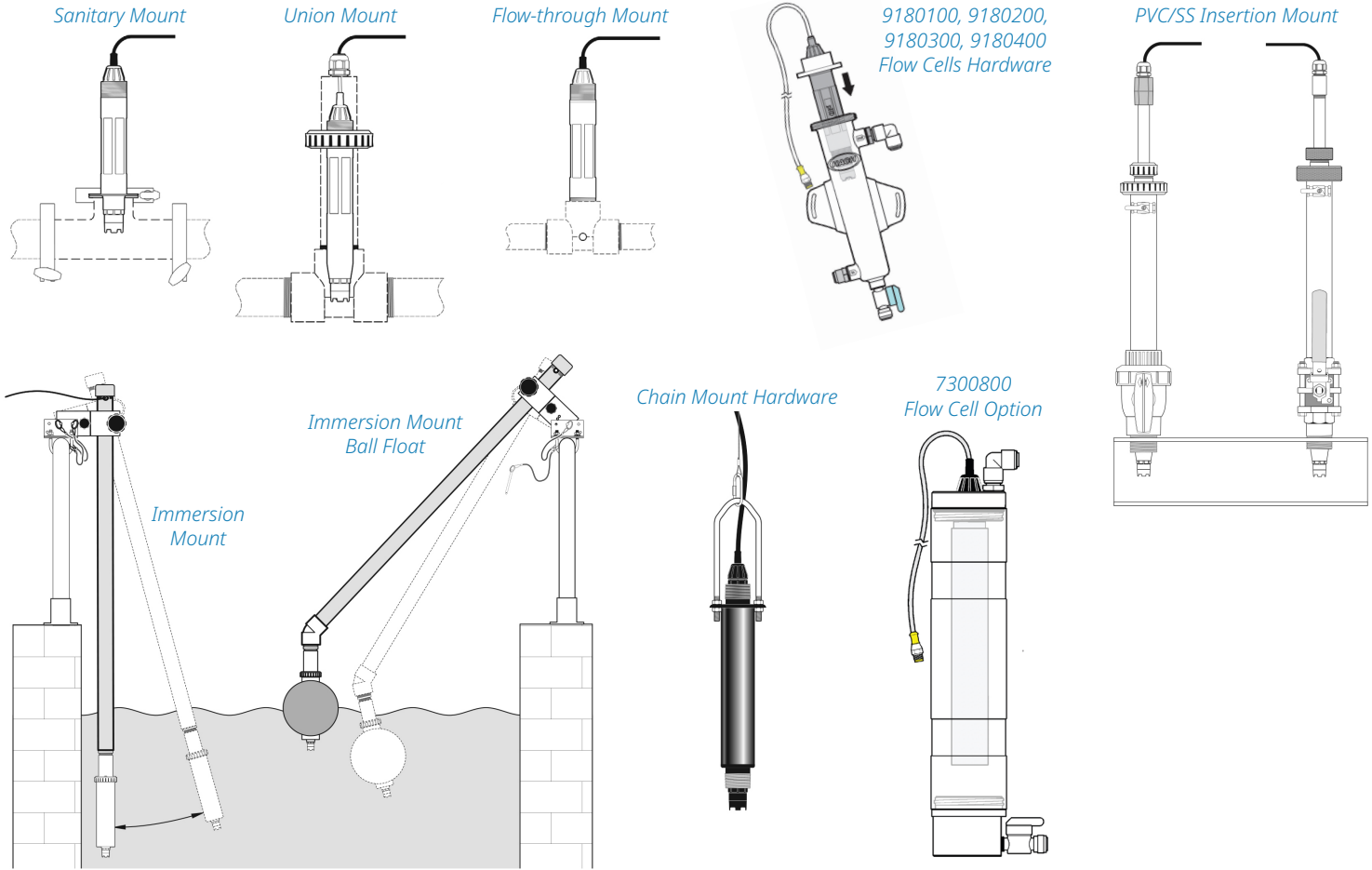

Sanitary Mount

MH018S8SZ 316 SS

Includes 2 inch sanitary tee and heavy-duty clamp. cap and EPDM compound gasket supplied with sensor; can be ordered separately.

Union Mount

6131300 CPVC

6131400 316 SS

Includes standard 1½ inch tee, union pipe with adapter, sealing hub, and lock ring and FKM/FPM O-ring.

Flow-through Mount

MH334N4NZ 316 SS

Includes a standard 1 inch tee in respective material.

Insertion Mount

Digital

5646300 CPVC

5646350 316 SS

Analog

5646400 CPVC

5646450 316 SS

Includes a 1½ inch ball valve, 1½ inch NPT close nipple, sensor adapter with two FKM/FPM O-rings and wiper, extension pipe, pipe adapter, back tube, and lock ring.

Immersion Mount

Standard Hardware

Digital

6136400 CPVC

6136500 316 SS

Analog

MH434A00B CPVC

MH414A00B 316 SS

Includes 1 inch by 4 ft. pipe and 1 inch x 1 inch NPT coupling (pipe-mount junction box with terminal strip included in analog hardware).

Handrail Hardware

MH236B00Z

Handrail Mounting Kit (for sensor to be used with either adapter above) includes 1.5-inch diameter by 7.5-ft long CPVC pipe and swivel/pivot/ pipe clamp assembly. Includes 1½ inch by 7.5 ft., CPVC pipe, and swivel/pivot pipe clamp assembly.

Chain Mount Hardware

2881900 316 SS

Includes stainless steel bail, nuts, and washers. Does not include chain. To be used with stainless steel immersion sensor only.

Ball Float Hardware

6131000 CPVC

Includes 1½ inch by 7.5 ft. CPVC pipe, ball float assembly, and swivel/pivot pipe clamp assembly.



World Headquarters: Loveland, Colorado USA | hach.com

United States 800-227-4224 fax: 970-669-2932 email: orders@hach.com
Outside United States 970-669-3050 fax: 970-461-3939 email: intl@hach.com

©Hach Company, 2025. All rights reserved.

In the interest of improving and updating its equipment, Hach Company reserves the right to alter specifications to equipment at any time.