



Chlorine Test Kit

CN-80 (2129000)

DOC326.98.00032

Test preparation

CAUTION: ⚠ *Review the Safety Data Sheets (MSDS/SDS) for the chemicals that are used. Use the recommended personal protective equipment.*

NOTICE: *This product has not been evaluated to test for chlorine and chloramines in medical applications in the United States.*

- Analyze samples immediately after collection.
- Put the color disc on the center pin in the color comparator box (numbers to the front).
- Use the 0–3.4 mg/L color disc for the low and mid-range procedures. Use the 0–10 mg/L color disc for the high-range procedure.
- Use sunlight or a lamp as a light source to find the color match with the color comparator box.
- Rinse the tubes with sample before the test. Rinse the tubes with deionized water after the test.
- To clean stains, use a mild detergent and brush, then fully rinse with deionized water.
- If the color match is between two segments, use the value that is in the middle of the two segments.
- If the color disc becomes wet internally, pull apart the flat plastic sides to open the color disc. Remove the thin inner disc. Dry all parts with a soft cloth. Assemble when fully dry.
- The long-path adapter for the low range test shows the color in the tubes from top to bottom. Make sure the light source is above the tubes during the color match.
- Undissolved reagent does not have an effect on test accuracy.
- For free chlorine, read the result immediately after the reagent is added to prevent interference from monochloramine. Only use the high range test for free chlorine when the sample water is superchlorinated.

Test procedure—Free or total chlorine, low range (0–0.68 mg/L Cl₂)

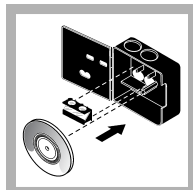

1. Install the long-path adapter in the color comparator box.

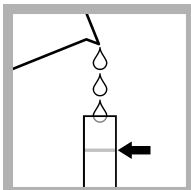

2. Fill a tube to the top line with sample.

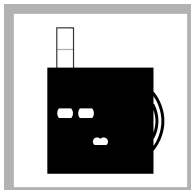

3. Put the tube into the left opening of the color comparator box.

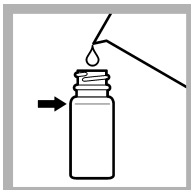

4. Fill the bottle to the 25-mL mark with sample.



5. Add one DPD (Free or Total) Chlorine Powder Pillow. Swirl to mix.



6. For free chlorine, read the result within 1 minute. For total chlorine, wait 3 minutes. Read the result within 6 minutes.

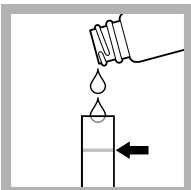

7. Fill a second tube to the top line with the prepared sample.

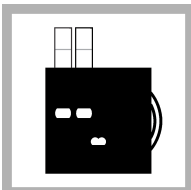

8. Put the second tube into the color comparator box.

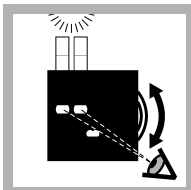

9. Hold the color comparator box below a light source. Turn the color disc to find the color match.

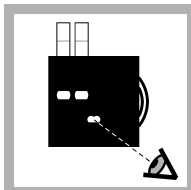

10. Read the value in the scale window. Divide the value by 5 to get the result in mg/L.

Replacement items

Description	Unit	Item no.
DPD Free Chlorine Reagent Powder Pillows, 25 mL	100/pkg	1407099
DPD Total Chlorine Reagent Powder Pillows, 25 mL	100/pkg	1406499
Bottle, square, with 25-mL mark	each	1704200
Color disc, DPD chlorine, 0–3.4 mg/L	each	990200
Color disc, DPD chlorine, 0–10 mg/L	each	9261600
Color comparator box	each	173200
Long-path adapter	each	2412200
Plastic viewing tubes, 18 mm, with caps	4/pkg	4660004
Tube insert, optical	each	2128800

Optional items

Description	Unit	Item no.
Brush, test tube	each	69000
Caps for plastic viewing tubes (4660004)	4/pkg	4660014
Detergent, Liqui-Nox	946 mL	2088153
Glass viewing tubes, 18 mm	6/pkg	173006
Stoppers for 18-mm glass tubes and AccuVac Ampuls	6/pkg	173106
Water, deionized	500 mL	27249

Test procedure—Free or total chlorine, mid range (0–3.4 mg/L Cl₂)

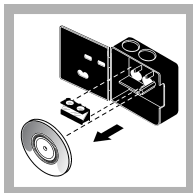

1. If installed, remove the long-path adapter.

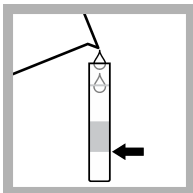

2. Fill a tube to the first line (5 mL) with sample.

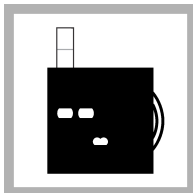

3. Put the tube into the left opening of the color comparator box.

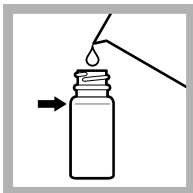

4. Fill the bottle to the 25-mL mark with sample.



5. Add one DPD (Free or Total) Chlorine Powder Pillow. Swirl to mix.



6. For free chlorine, read the result within 1 minute. For total chlorine, wait 3 minutes. Read the result within 6 minutes.

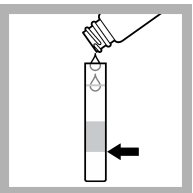

7. Fill a second tube to the first line (5 mL) with the prepared sample.

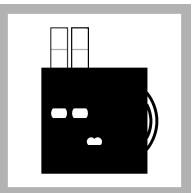

8. Put the second tube into the color comparator box.

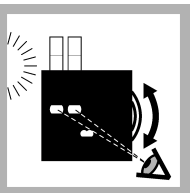

9. Hold the color comparator box in front of a light source. Turn the color disc to find the color match.

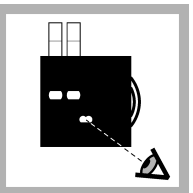

10. Read the result in mg/L in the scale window.

Test procedure—Free or total chlorine, high range (0–10 mg/L Cl₂)

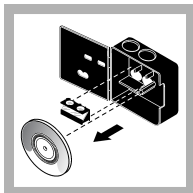

1. If installed, remove the long-path adapter.

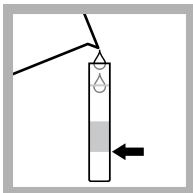

2. Fill a tube to the first line (5 mL) with sample.

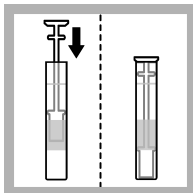

3. Add an optical tube insert.

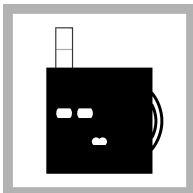

4. Put the tube into the left opening of the color comparator box.

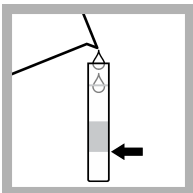

5. Fill a second tube to the first line (5 mL) with sample.

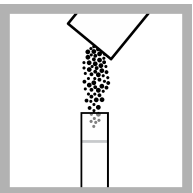

6. Add one DPD (Free or Total) Chlorine Powder Pillow to the second tube.



7. For free chlorine, read the result within 1 minute. For total chlorine, wait 3 minutes. Read the result within 6 minutes.

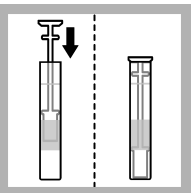

8. Add an optical tube insert to the second tube.

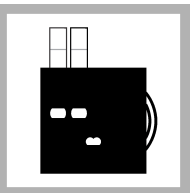

9. Put the second tube into the color comparator box.

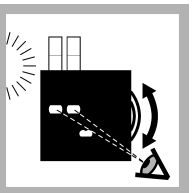

10. Hold the color comparator box in front of a light source. Turn the color disc to find the color match.

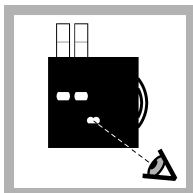

11. Read the result in mg/L in the scale window.

