

REVISION		
REV	DESCRIPTION	APPROVED
B	REVISED PER 11-842	WHITE, STEVE

SC200 OVERALL DIMENSIONS

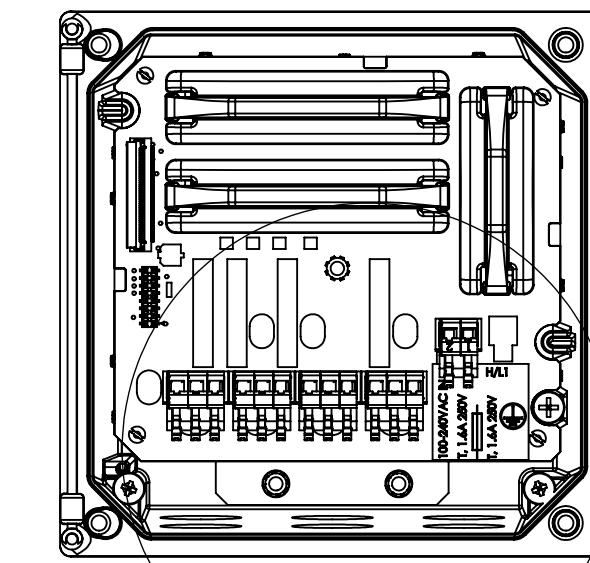
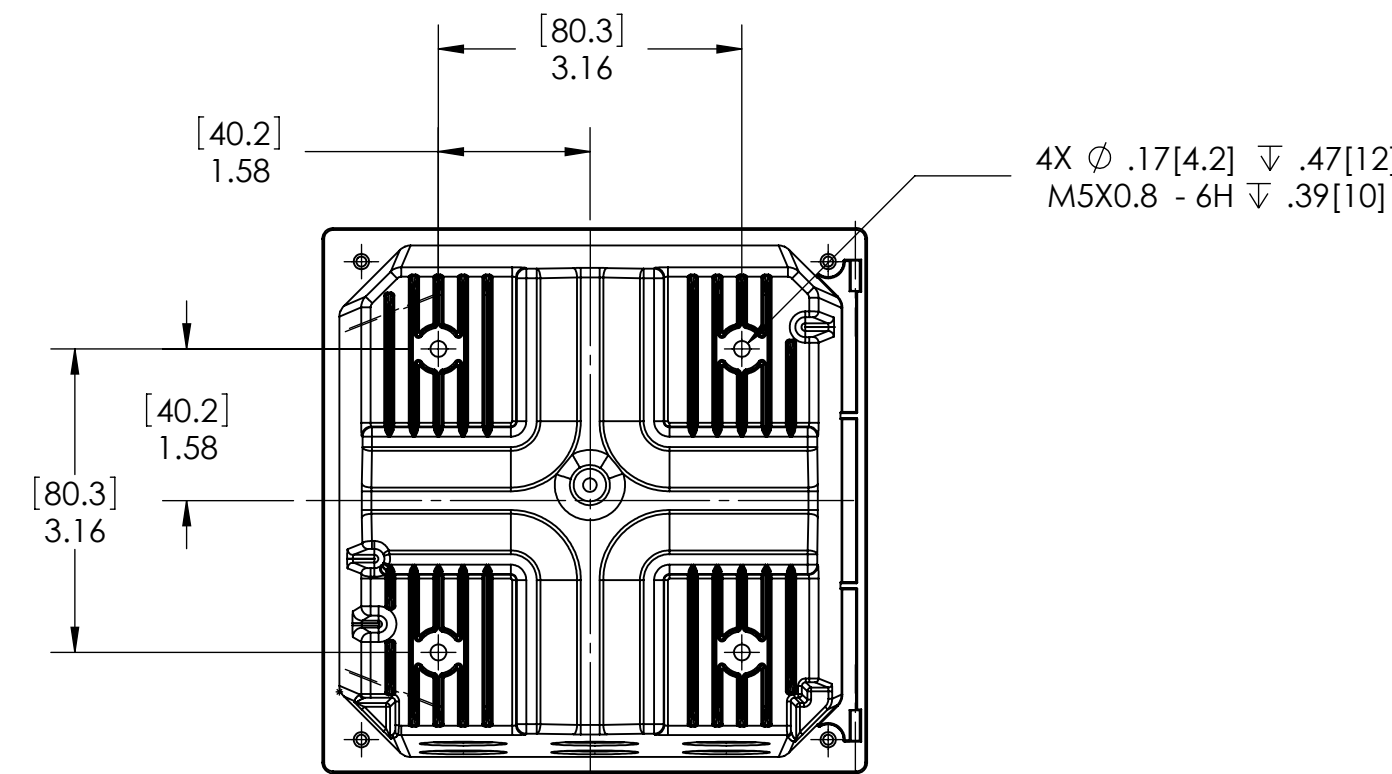
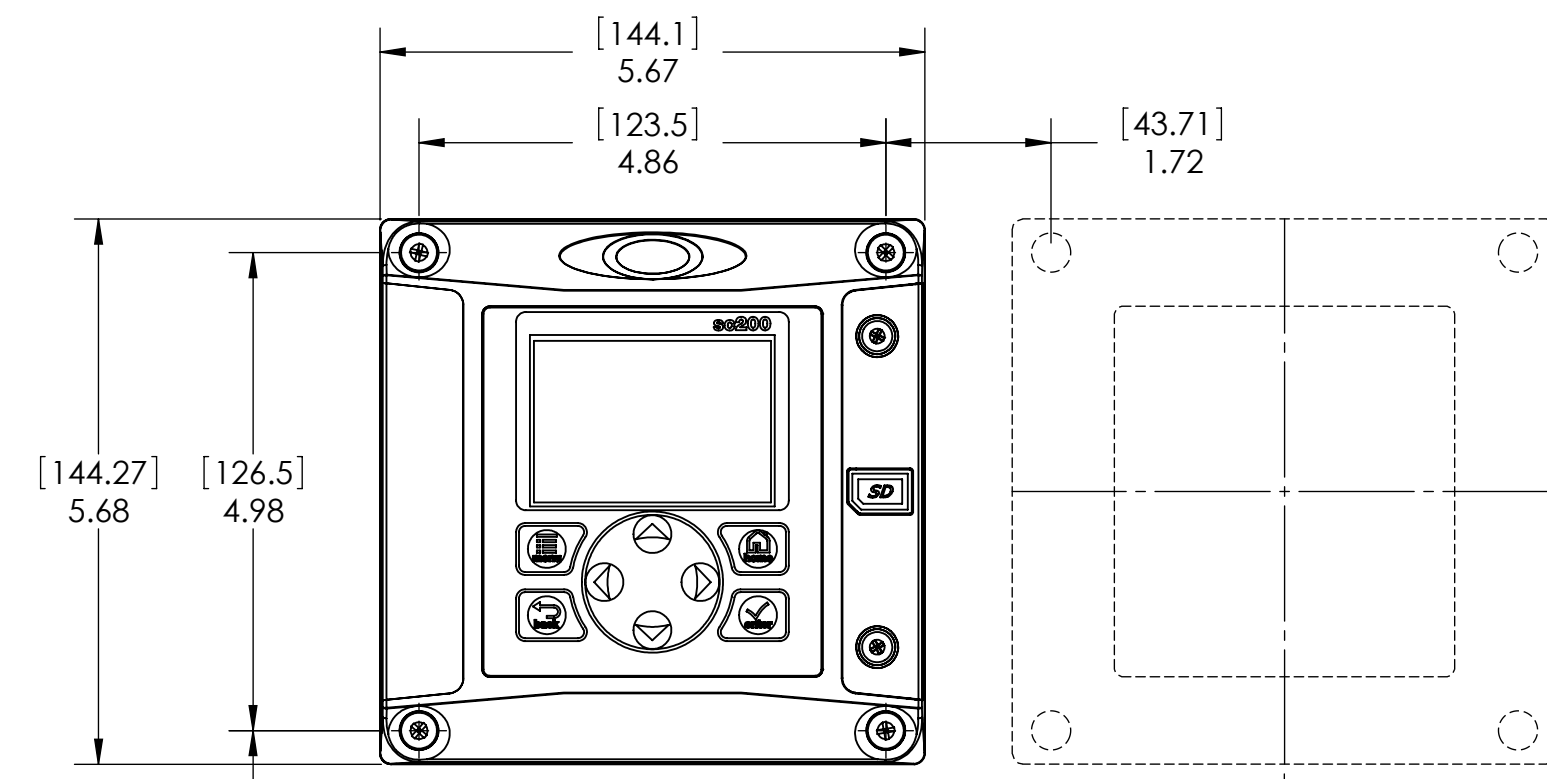

CUSTOMER CONNECTIONS
ITEMS REMOVED FOR CLARITY

MINIMUM SPACING DIMENSIONS FOR GROUP MOUNTING

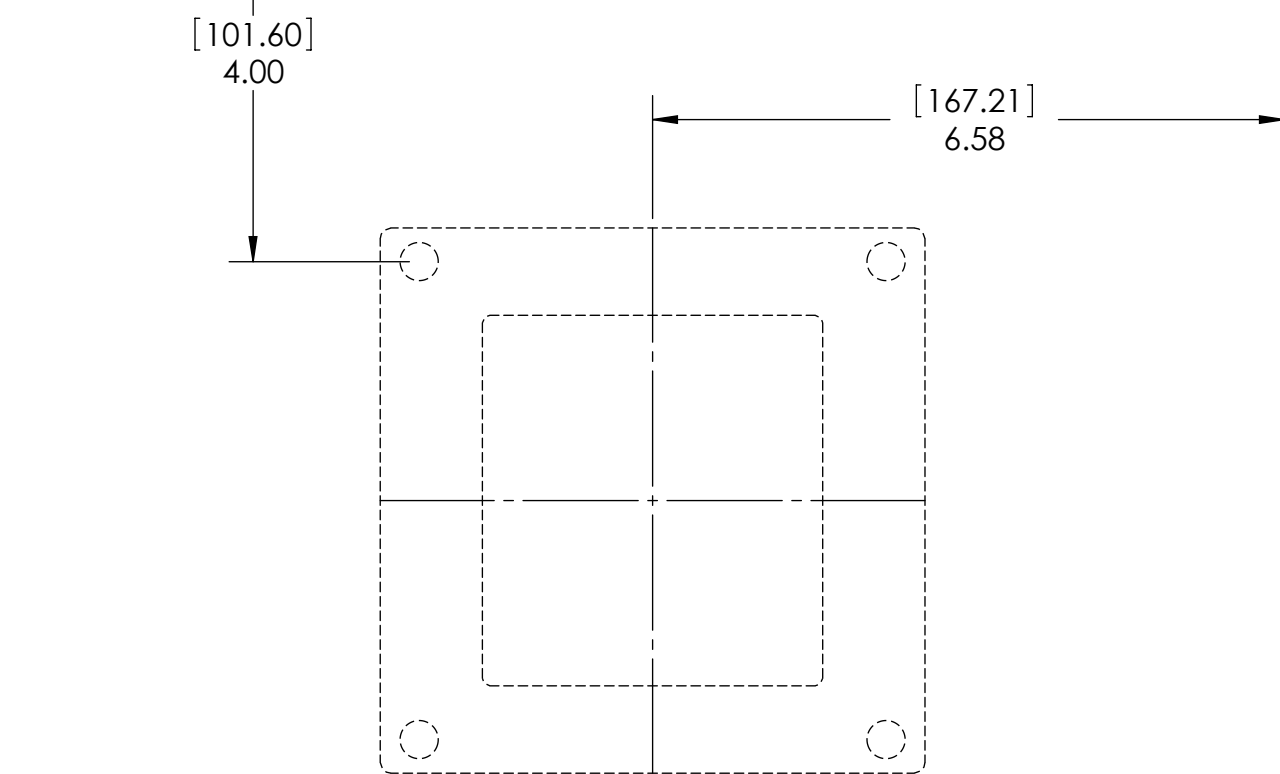

MOUNTING DIMENSIONS

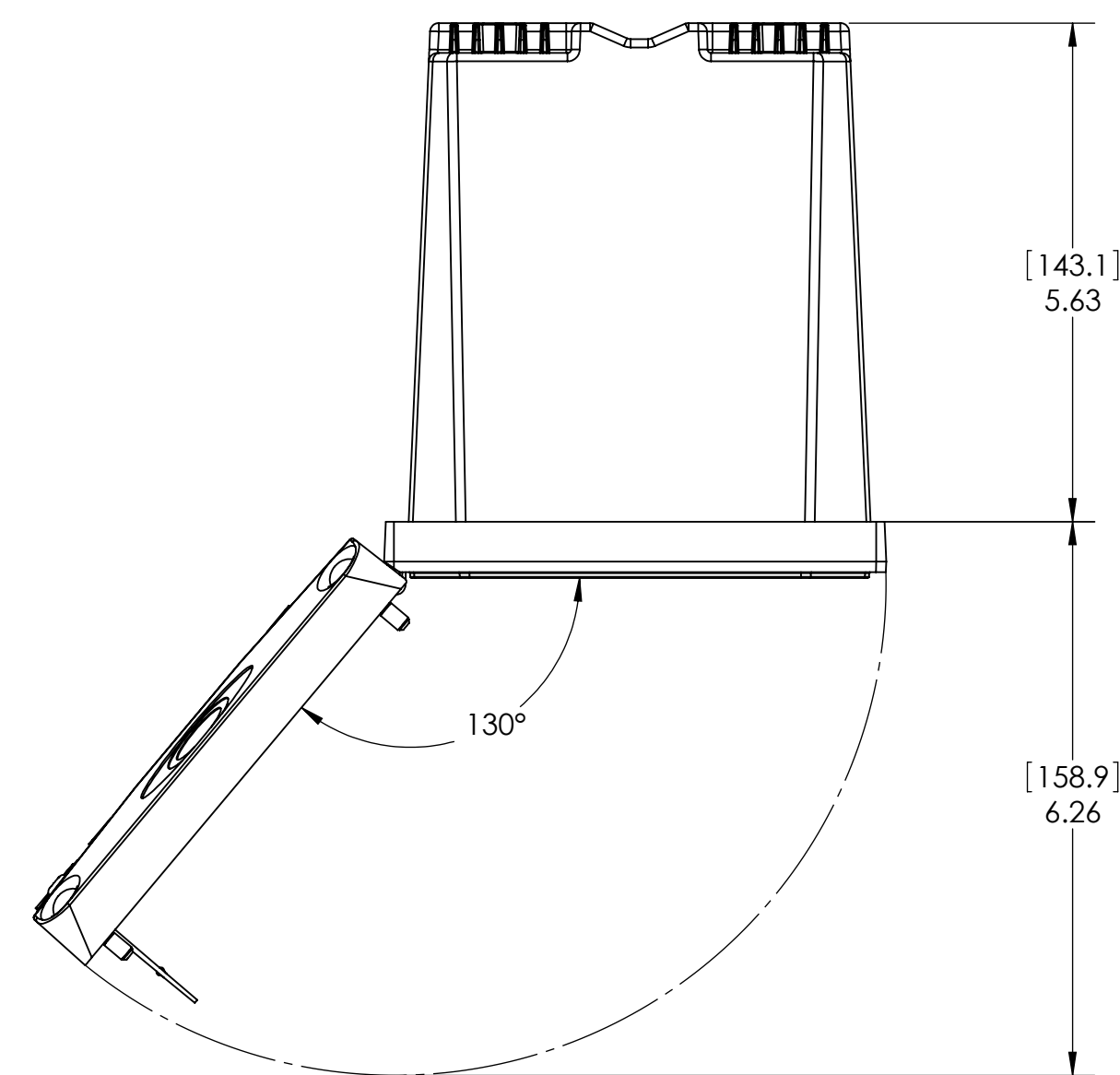

DOOR OPENING DETAILS

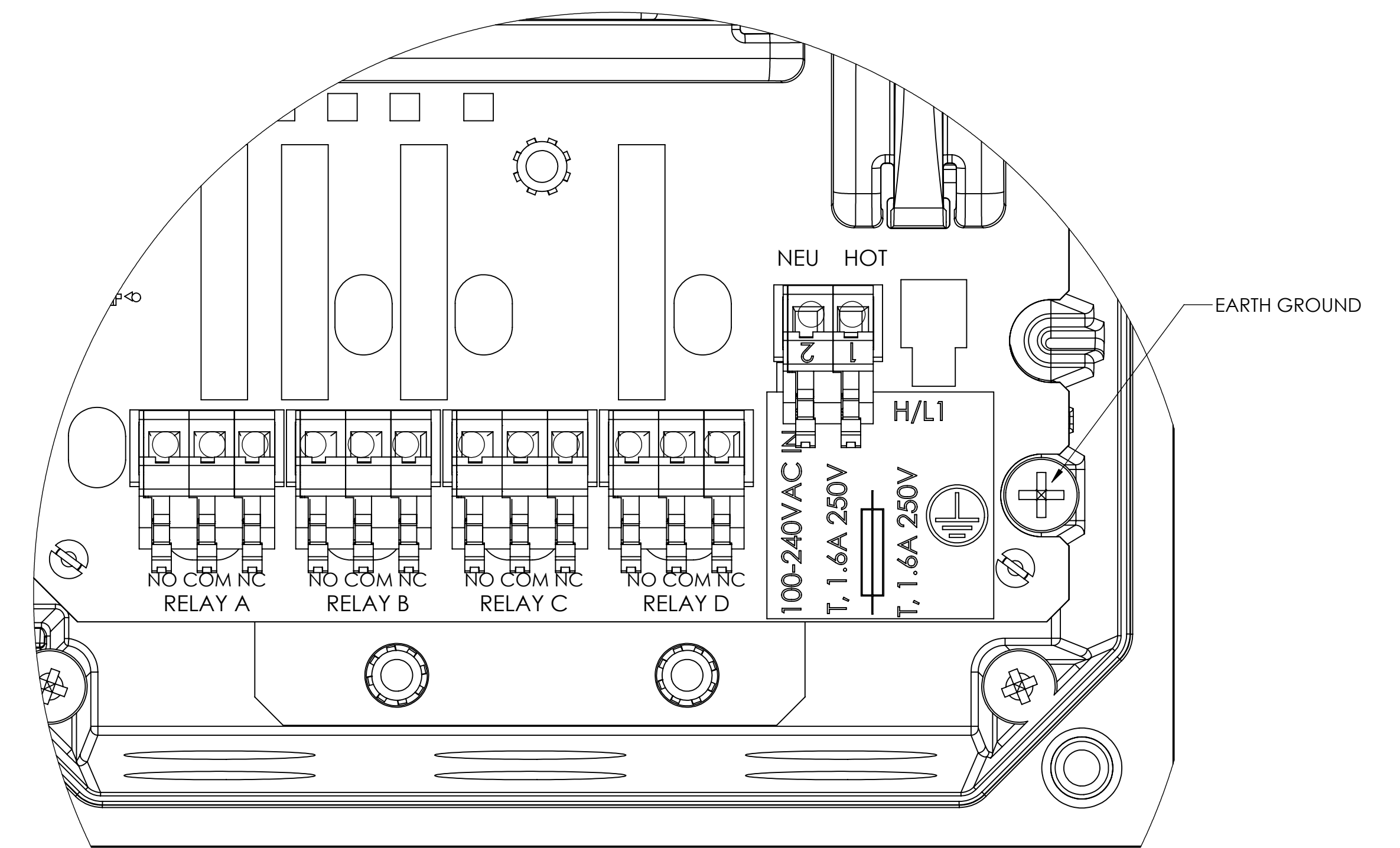
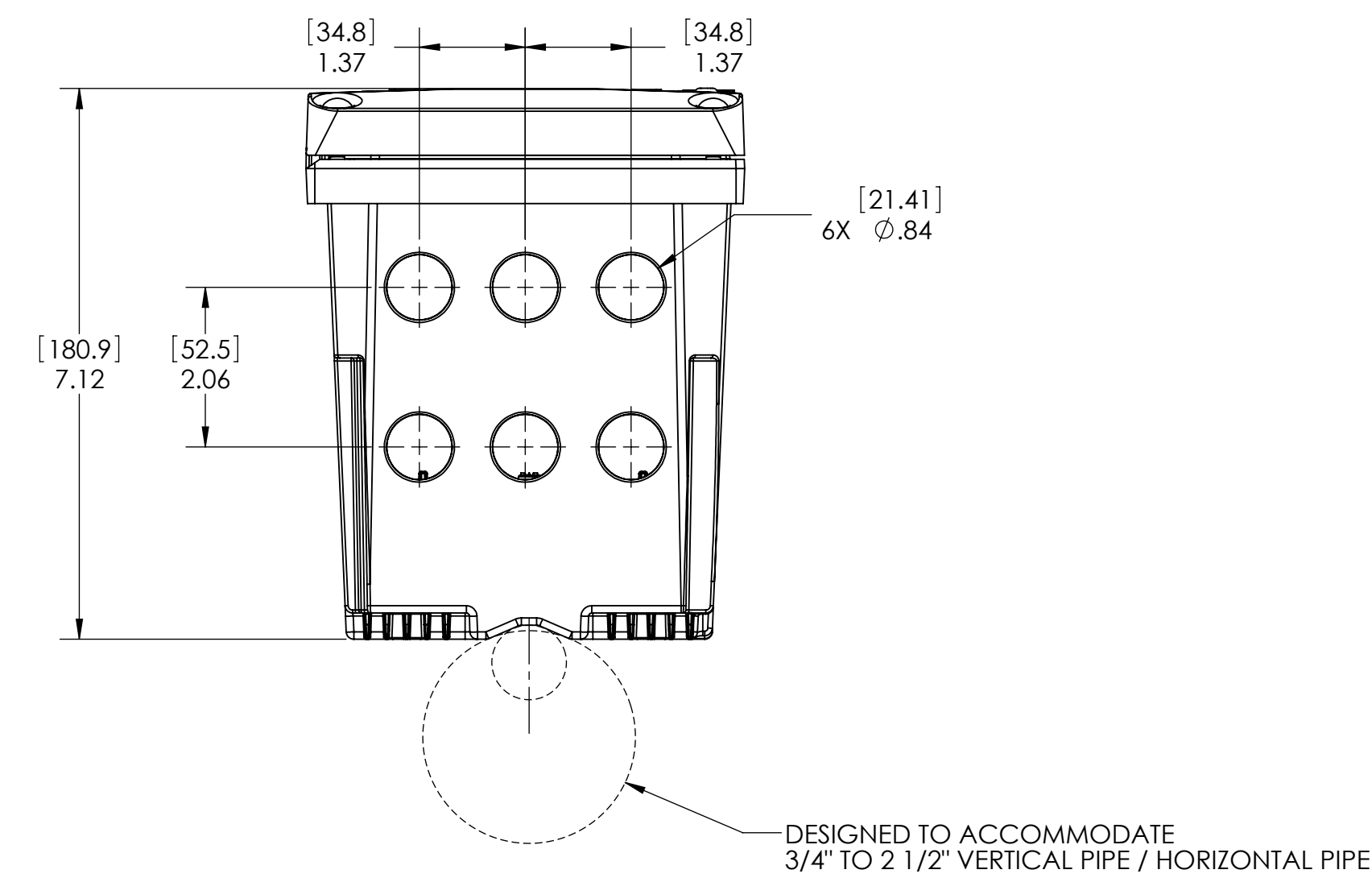

DETAIL B
SCALE 2 : 1

GENERAL INFORMATION:

1. CONTROLLER OPERATING TEMPERATURE : -20 TO 60°C (-4 TO 140°F); 95% HUMIDITY, NON CONDENSING.
2. CONTROLLER STORAGE TEMPERATURE: -20 TO 70°C (-4 TO 158°F); 95% RELATIVE HUMIDITY, NON CONDENSING.
3. ENCLOSURE: NEMA 4X / IP66 METAL ENCLOSURE WITH A CORROSION RESISTANT FINISH.
4. CONTROLLER WEIGHT: 1.6 Kg (3.5 lb).

NOTES:
1. ALL THE DIMENSION ARE IN INCHES [MILLIMETERS].

NOTICE-HACH COMPANY CLAIMS PROPRIETARY RIGHTS IN THE INFORMATION DISCLOSED ON THIS DRAWING. IT IS ISSUED IN CONFIDENCE FOR ENGINEERING INFORMATION ONLY AND MAY NOT, IN WHOLE OR IN PART, BE USED TO MANUFACTURE ANYTHING, WHETHER OR NOT SHOWN HEREON, REPRODUCED OR DISCLOSED TO ANYONE WITHOUT DIRECT PERMISSION FROM HACH COMPANY.

MATERIAL	UNLESS OTHERWISE SPECIFIED: DIMENSIONS ARE IN INCHES TOLERANCES: X = ±.03 XX = ±.01 XXX = ±.005 ANGLES = ±.25°	NAME	DATE	HACH COMPANY 5600 LINDBERH DR. LOVELAND, CO. 80539						
	INTERPRET GEOMETRIC TOLERANCING PER: ANSI Y14.5M 1994	DRAWN ENGINEER			TITLE: TRANSMITTAL, sc200					
	DO NOT SCALE THIS SHEET	THIRD ANGLE PROJECTION		<table border="1"> <tr> <td>SIZE</td> <td>DWG. NO.</td> <td>REV</td> </tr> <tr> <td>D</td> <td>9015087</td> <td>B</td> </tr> </table>	SIZE	DWG. NO.	REV	D	9015087	B
SIZE	DWG. NO.	REV								
D	9015087	B								

SCALE: 1:2 WEIGHT: SHEET 1 OF 2

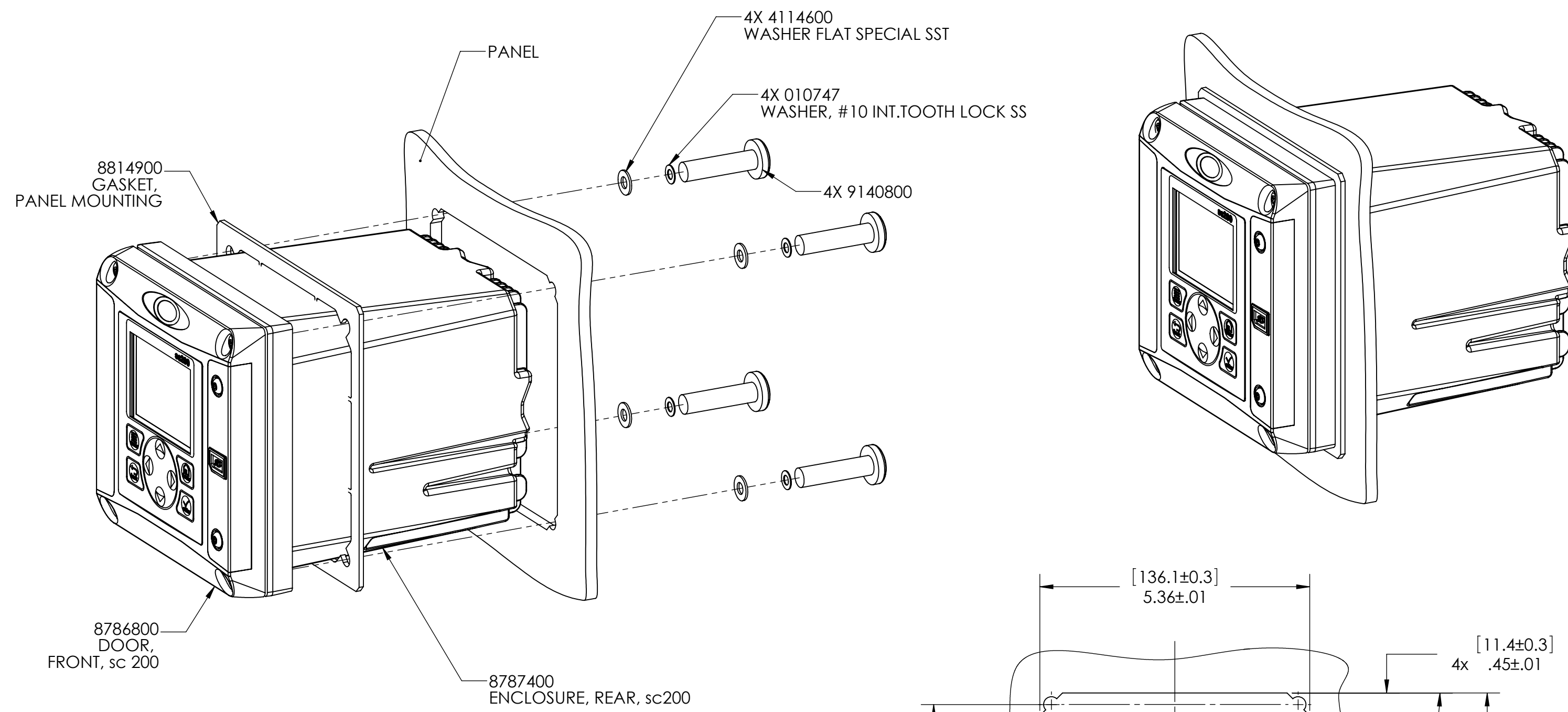

PANEL MOUNT

NOTE: ALL CONNECTIONS ON THE BASE OF THE ENCLOSURE ARE TO BE REMOVED WHEN INSTALLING THE CONTROLLER IN PANEL.

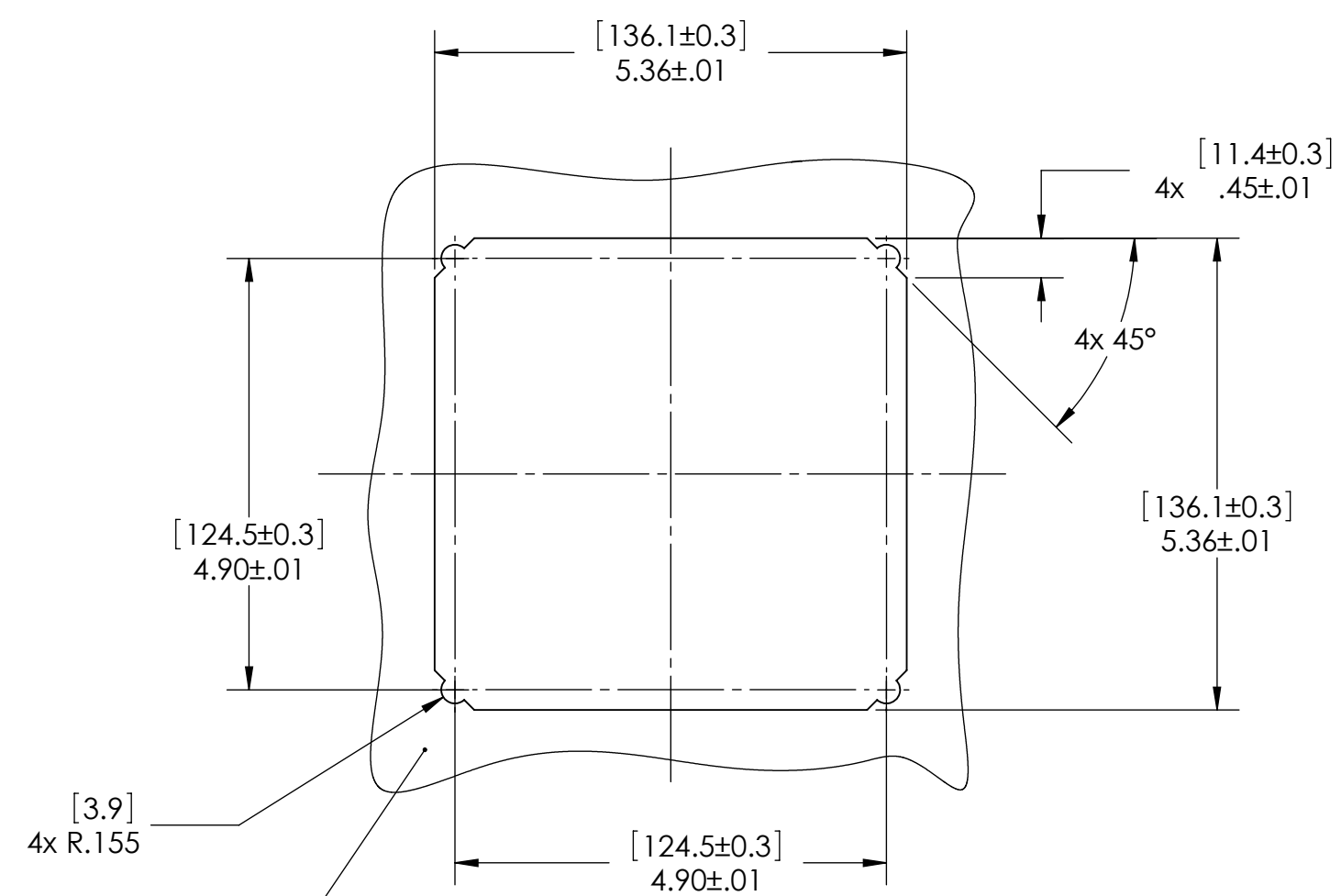

PANEL MOUNT CUTOUT

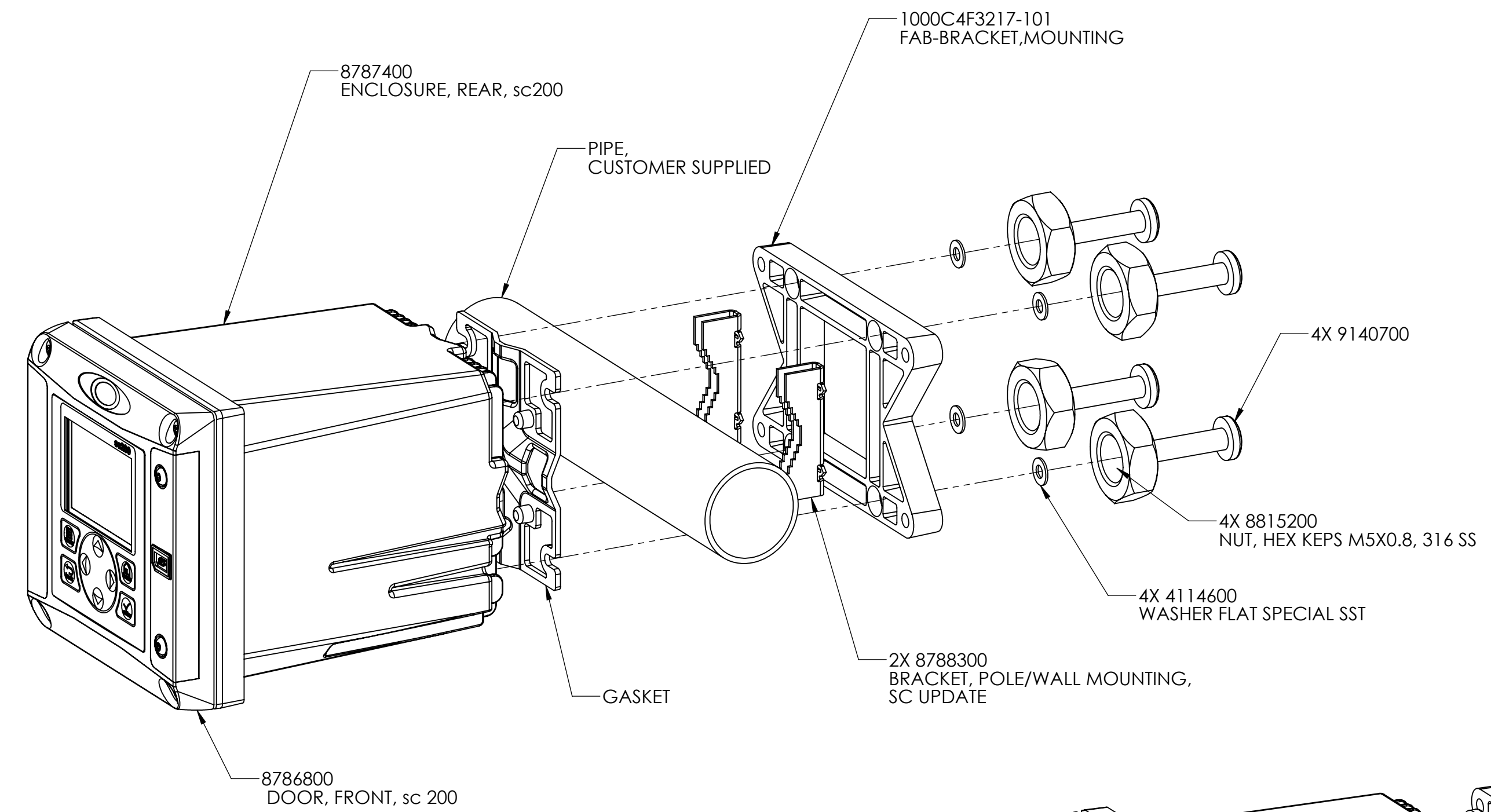

PIPE MOUNT (HORIZONTAL)

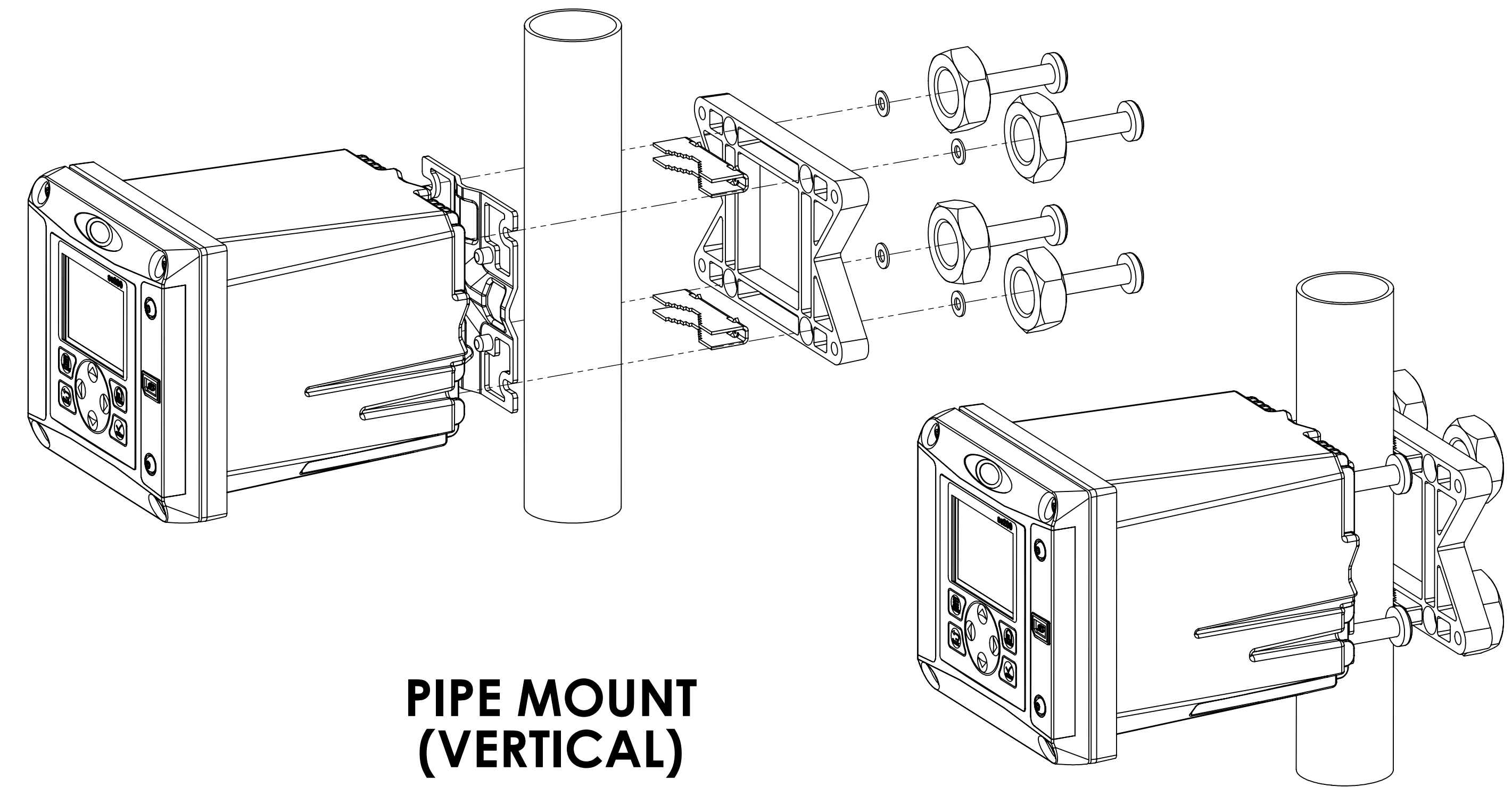

PIPE MOUNT (VERTICAL)

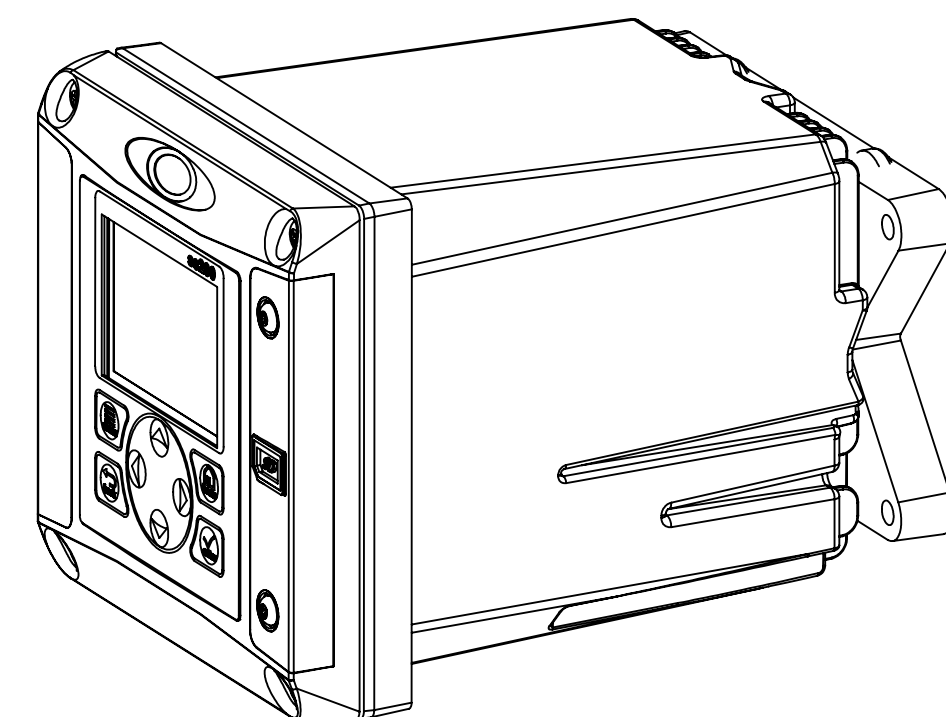
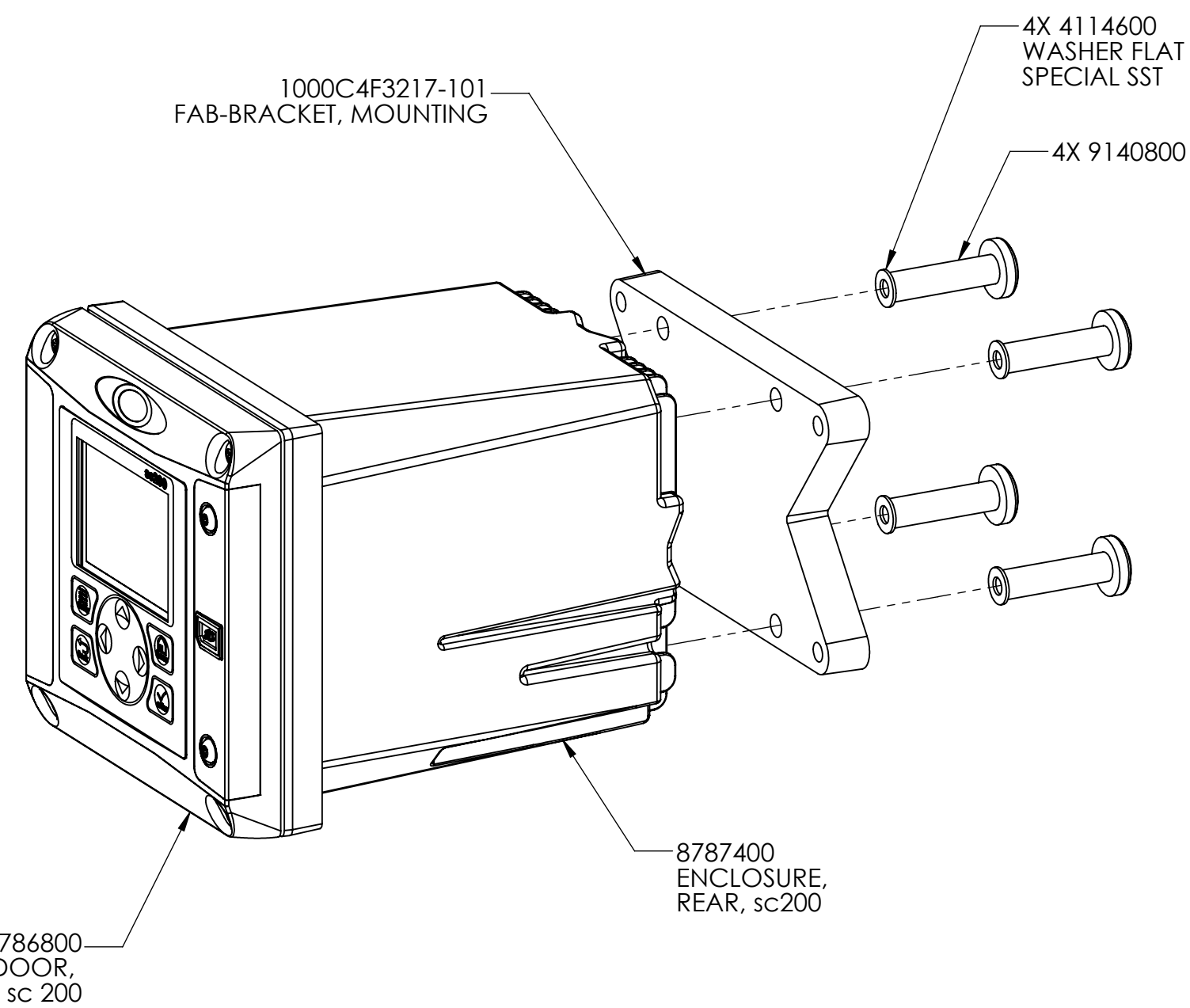

BRACKET (SUPPLIED) FOR WALL, PANEL AND PIPE MOUNTING

NOTE: VIBRATION MOUNT GASKET IS OPTIONAL DEPENDING ON APPLICATION.

WALL MOUNT